



DESCRIPTION

OF WYANDOTT RESERVE No 12

First- The South East quarter of the South East of Section Number Twenty-five, and the North East quarter of the North East quarter of Section Number Thirty Six, both in Township Twelve, South of Range Nineteen, East of the Sixth Principal Meridian

Second- Lots Number Two and Three of Section Number Thirty. Lot Number Two of Section Number East quarter of Section Number Thirty One. The North West quarter of Section Number Thirty One, Thirty One, the West half of the South East quarter of Section Number Thirty One, and the South West quarter of Section Number Thirty One, all of the second part being in Township Twelve South of Range Twenty, East of the Sixth Principal Meridian

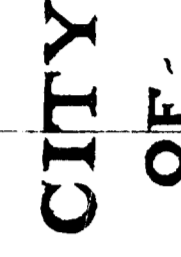

CITY OF LAWRENCE, KANSAS. AS EMBRACED WITHIN WYANDOTT RESERVE No 12.

SCALE - ONE INCH TO 300 FEET.

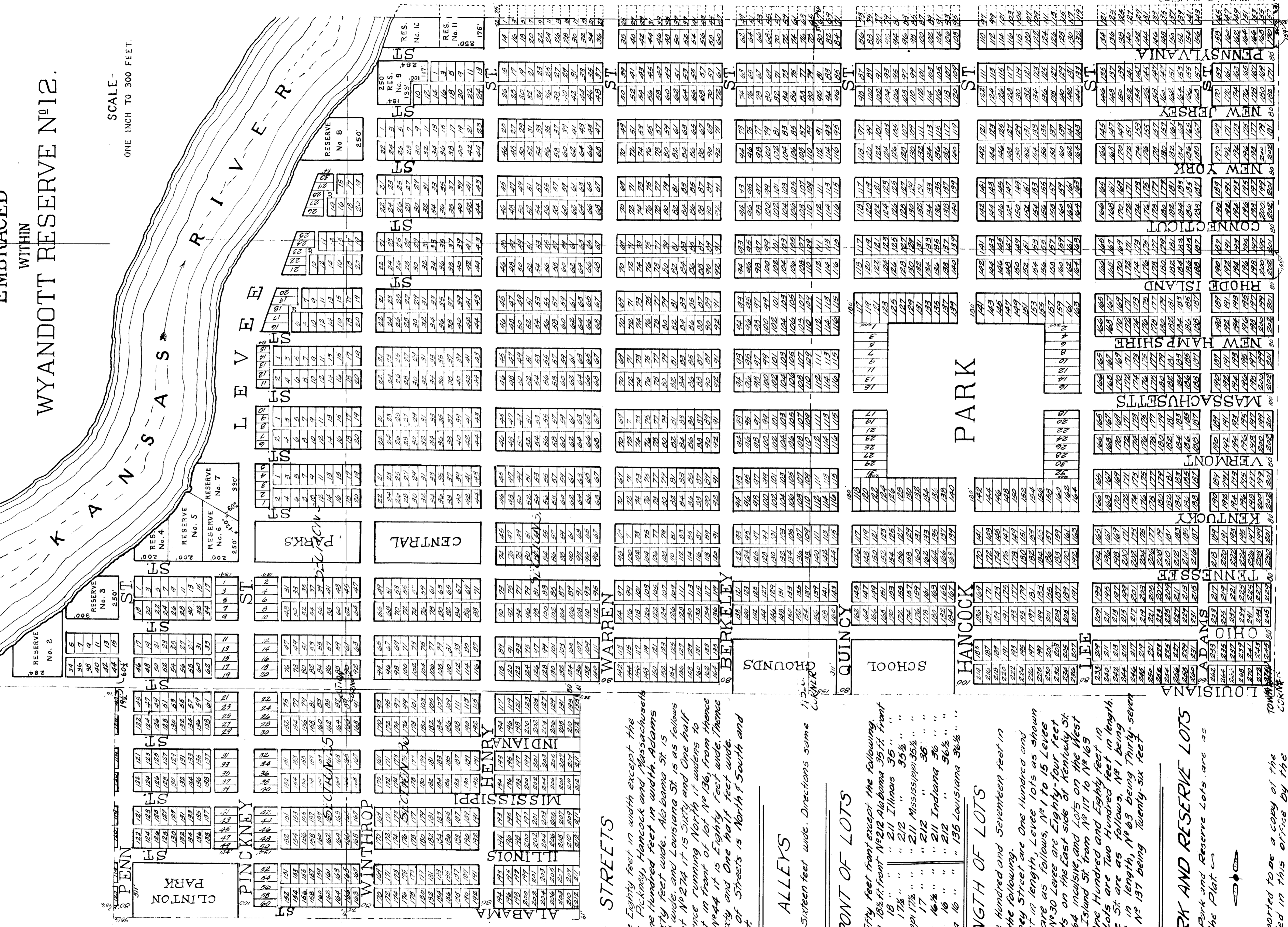

STREETS

All Streets are Eighty feet in width except the following: Pickney, Hancock and Massachusetts Streets are One Hundred feet in width, Adams Street is Sixty feet wide, Alabama St is Sixty one feet wide, and Louisiana St is as follows: In front of lot No 274 it is Sixty and One half feet wide; Thence running North it widens to Sixty one feet in front of lot No 136, from thence North to lot No 44 it is Eighty feet wide. Thence the direction of Street is North & South and East & West.

ALLEYS

All alleys are Sixteen feet wide. Directions same as Streets

FRONT OF LOTS

- All lots are Fifty feet front except the following: No 120 Alabama 183 ft front No 212 Alabama 35 ft front No 119 Illinois 18 " " 212 Illinois 35 " " No 120 Mississippi 17 " " 212 Mississippi 35 " " No 119 Indiana 16 " " 212 Indiana 36 " " No 120 Louisiana 16 " " 135 Louisiana 36 " " 43 Louisiana 36 " "

LENGTH OF LOTS

All lots are One Hundred and Seventeen feet in length except the following: Lots on Pickney Street are One Hundred and Thirty-four feet in length, Levee lots as shown on the Plat are as follows, No 1 to 15 Levee inclusive and No 30 Levee are Eighty-four feet in length. Lots on the East side of Kentucky St from No 118 to 164 inclusive, and Lots on the West side of Rhode Island St from No 117 to No 163 inclusive are One Hundred and Eighty feet in length. Park Lots are Two Hundred feet in length. Lots on Delaware St are as follows, No 1 being Forty-two feet in length, No 63 being Thirty-seven feet in length, No 137 being Twenty-six feet in length.

PARK AND RESERVE LOTS

Dimensions of Park and Reserve Lots are as indicated on the Plat.

This Plat purposed to be a copy of the original as filed in this office by the Trustees of Lawrence Township and which was destroyed in the fire on August 21, 1863.

S. S. Horton Register of Deeds