

L	A	B	C	D	E	F	G
<80'	ONE	ARROW					
81'-100'	30'	30'	21'-40'				
101'-120'	40'	40'	21'-40'				
121'-140'	45'	45'	31'-50'				
141'-160'	55'	55'	31'-50'				
161'-180'	65'	65'	31'-50'				
181'-200'	75'	75'	31'-50'				
201'-220'	80'	80'	41'-60'				
221'-240'	45'	45'	45'	45'	41'-60'		
241'-260'	50'	50'	50'	50'	41'-60'		
261'-280'	55'	55'	55'	55'	41'-60'		
281'-300'	60'	60'	60'	60'	41'-60'		
301'-320'	65'	65'	65'	65'	41'-60'		
321'-340'	70'	70'	70'	70'	41'-60'		
341'-360'	75'	75'	75'	75'	41'-60'		
361'-380'	80'	80'	80'	80'	41'-60'		
381'-400'	55'	55'	55'	55'	55'	51'-70'	
401'-420'	60'	60'	60'	60'	60'	41'-60'	
421'-440'	65'	65'	65'	65'	65'	31'-50'	
441'-460'	65'	65'	65'	65'	65'	51'-70'	
461'-480'	70'	70'	70'	70'	70'	41'-60'	
481'-500'	75'	75'	75'	75'	75'	31'-50'	
>500'	80'	80'	80'	80'	80'	80'	Varies

TURN LANE WORD AND SYMBOL SPACING SCHEDULE

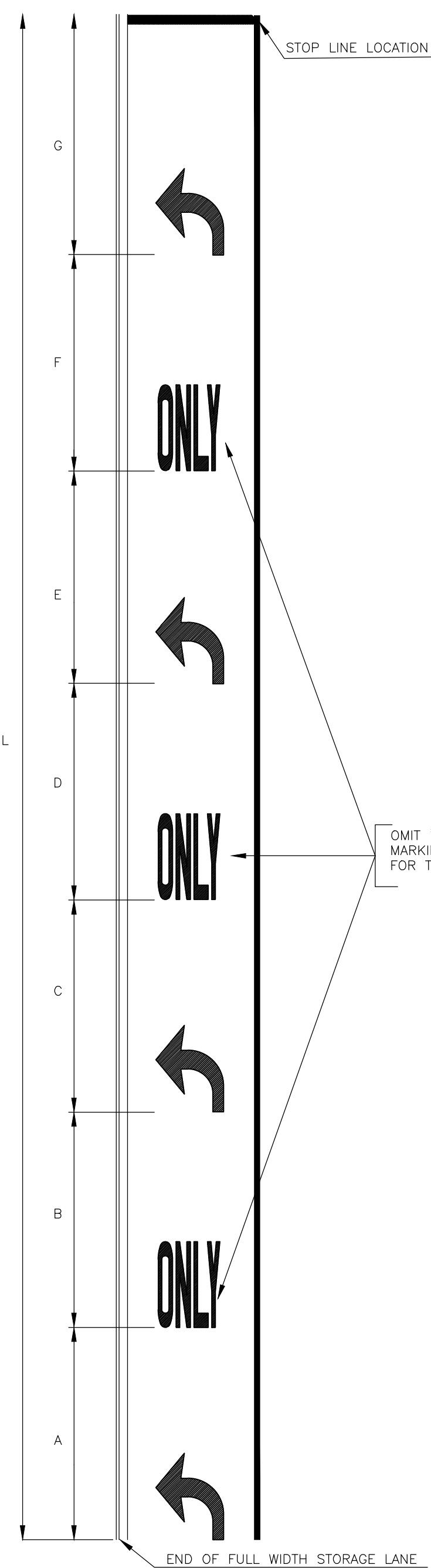

OMIT "ONLY" MARKINGS EXCEPT FOR TRAP LANES.

TURN LANE WORD AND SYMBOL LAYOUT

TURN LANE WORD AND SYMBOL SPACING INFORMATION

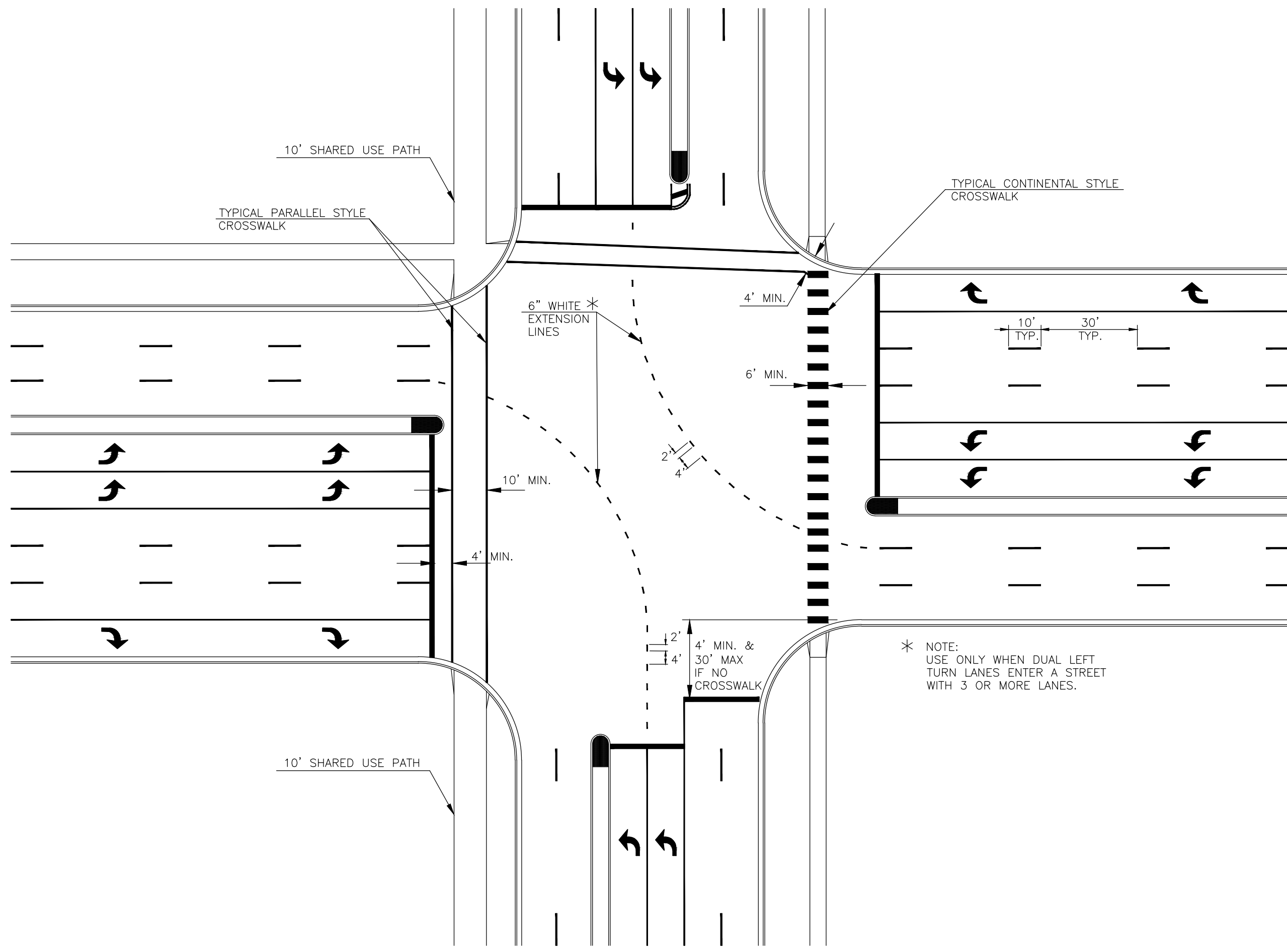

TYPICAL CROSSWALK AND LEFT TURN EXTENSION LINE MARKINGS

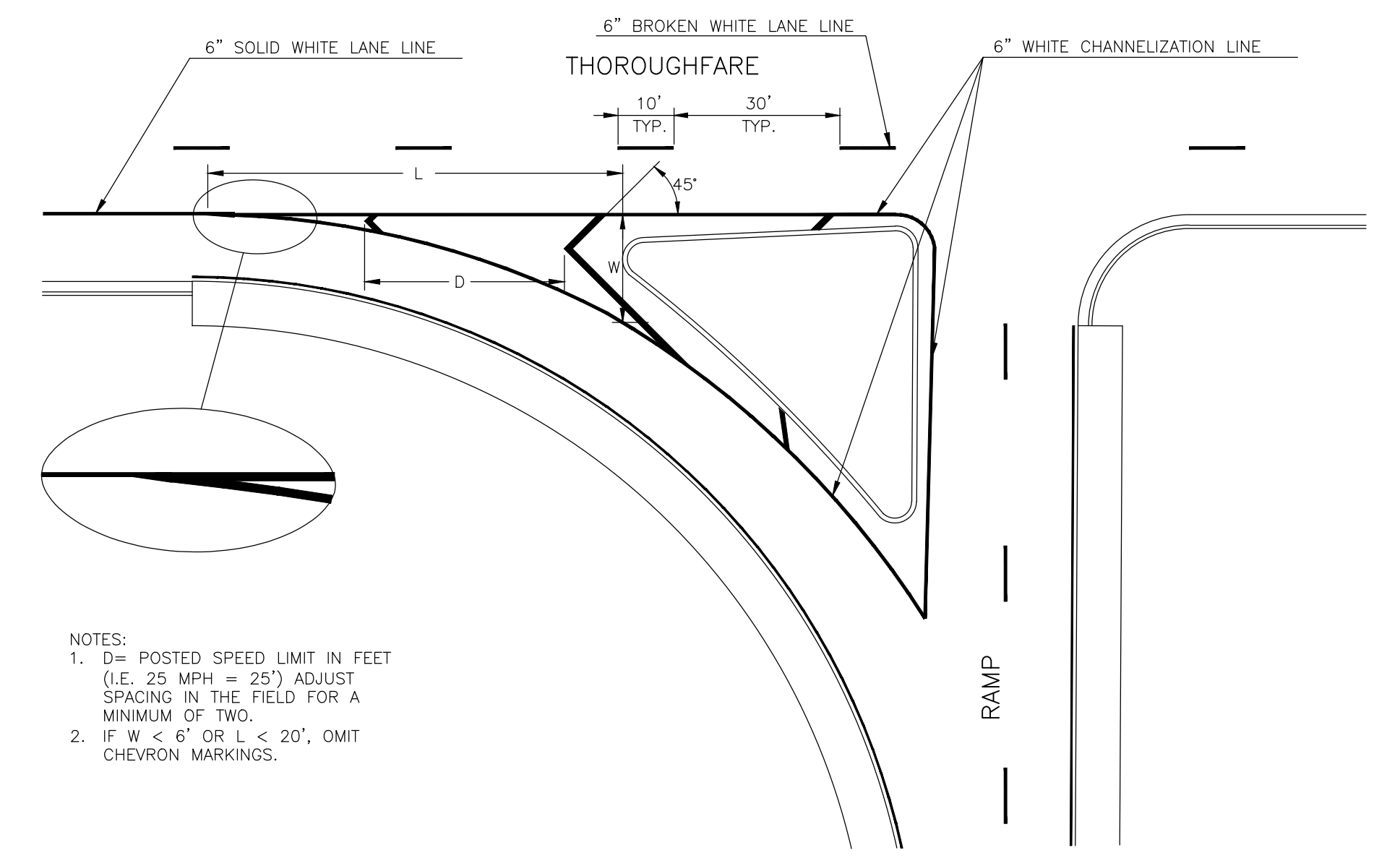

TYPICAL MARKINGS AT DIRECTIONAL ISLANDS

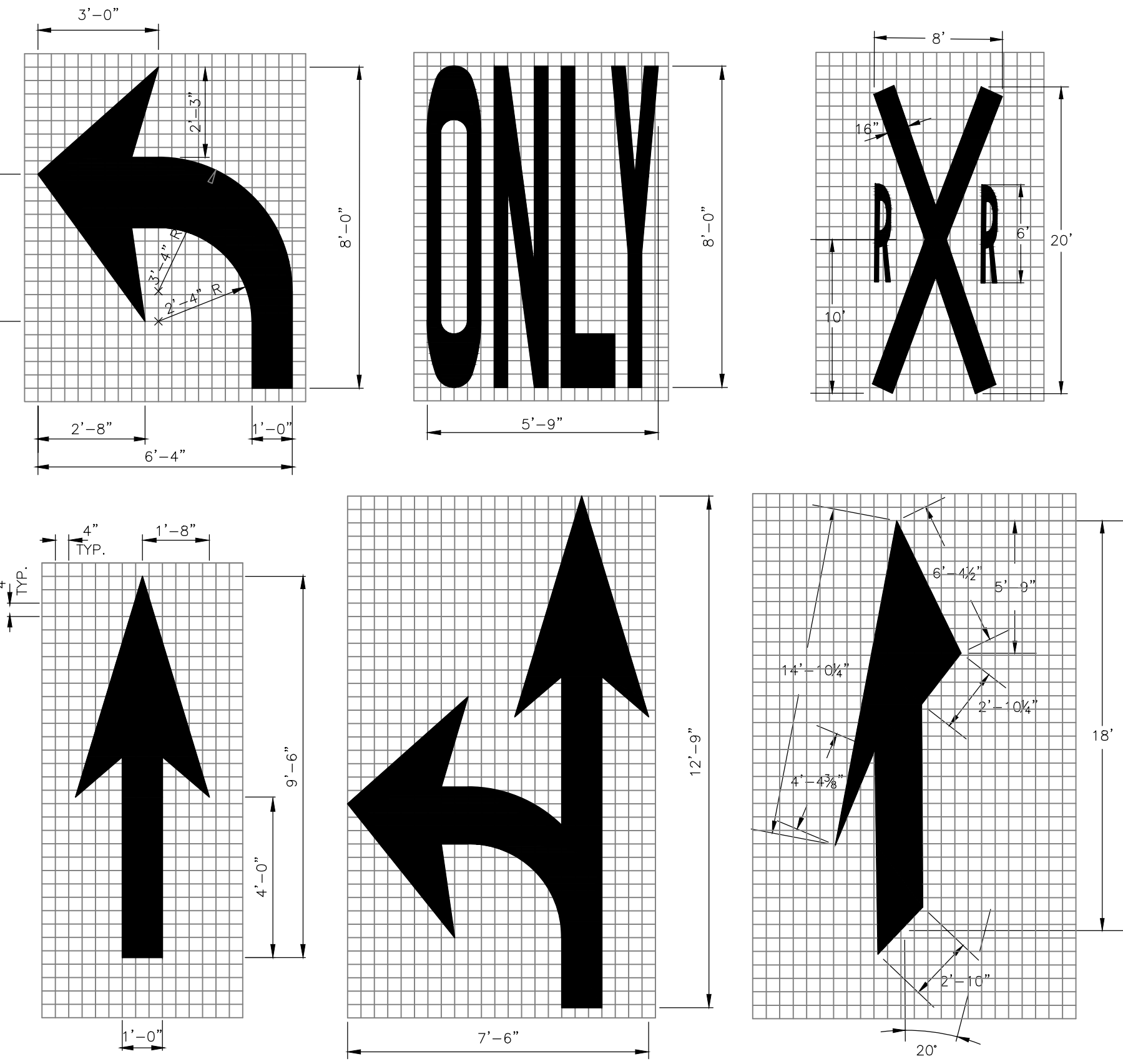

WORD AND SYMBOL DETAILS

NOTES:
1) WORD & SYMBOL MARKINGS SHALL BE WHITE.
2) RIGHT TURN AND COMBINATION RIGHT TURN/STRAIGHT ARROWS ARE REVERSE OF ARROWS SHOWN.

PAVEMENT MARKING GENERAL NOTES

- ALL PERMANENT PAVEMENT MARKINGS SHALL BE PROVIDED AND INSTALLED BY THE CONTRACTOR AS INDICATED IN THE PLANS OR AS DIRECTED BY THE CITY INSPECTOR. PAVEMENT MARKINGS ON CONCRETE SHALL BE PER THE SPECIFICATIONS, UNLESS OTHERWISE INDICATED ON THE PLANS OR DIRECTED BY THE CITY INSPECTOR. SEE THE PAVEMENT MARKING MATERIAL MATRIX.
- ALL PATTERNED COLD PLASTIC AND CONTRAST PATTERNED COLD PLASTIC PAVEMENT MARKING MATERIAL, INCLUDING SYMBOLS AND WORDS, INSTALLED ON CONCRETE SPEED HUMPS, SHALL HAVE A BLACK CONTRASTING EDGE. CONCRETE PAVEMENT BENEATH MARKING SHALL BE GROOVED, USING A METHOD APPROVED BY THE ENGINEER, TO FACILITATE ATTACHMENT (SUBSIDIARY). INSTALLATION SHALL BE PERFORMED WITH A MATERIAL COMPLIANT SEALER.
- ALL PREFORMED THERMOPLASTIC AND THERMOPLASTIC PAVEMENT MARKING MATERIAL SHALL BE INSTALLED WITH A MATERIAL COMPLIANT SEALER.
- INSTALLATION OF ALL PAVEMENT MARKING MATERIALS SHALL BE PERFORMED TO MANUFACTURER'S RECOMMENDATIONS.
- PAVEMENT MARKINGS ON ASPHALT SHALL BE PER THE SPECIFICATIONS, UNLESS OTHERWISE INDICATED ON THE PLANS OR DIRECTED BY THE CITY INSPECTOR. SEE THE PAVEMENT MARKING MATERIAL MATRIX.
- ALL PATTERNED COLD PLASTIC AND CONTRAST PATTERNED COLD PLASTIC PAVEMENT MARKING MATERIAL SHALL BE LAID IN HOT ASPHALT WHEN INSTALLED IN CONJUNCTION WITH AN OVERLAY PROJECT. FOR EXISTING SURFACES, ASPHALT PAVEMENT BENEATH MARKING SHALL BE GROOVED USING A METHOD APPROVED BY THE ENGINEER, TO FACILITATE ATTACHMENT (SUBSIDIARY). INSTALLATION SHALL BE PERFORMED WITH A MATERIAL COMPLIANT SEALER.
- CROSSWALK LINES SHALL BE INSTALLED SUCH THAT THE MINIMUM DISTANCE BETWEEN THE INSIDE EDGE OF THE LINE TO THE INSIDE EDGE OF LINE IS 6 FEET, AND SPACED TO AVOID WHEEL PATHS.
- STOP LINES SHALL BE INSTALLED SUCH THAT THE MINIMUM DISTANCE BETWEEN THE OUTSIDE EDGE OF THE BACK CROSSWALK LINE AND THE TRAILING EDGE OF THE STOP LINE IS 4 FEET.
- SKIP LINES SHALL NOT EXTEND PAST THE STOP BAR OR INTO THE CROSSWALK. WHITE BROKEN LANE LINES SHALL BE CARRIED THROUGH INTERSECTIONS WITH PRIVATE STREETS UNLESS THERE IS A LEFT TURN BAY INTO THE PRIVATE STREET. THEN A GAP SHOULD BE LEFT IN THE BROKEN WHITE LANE LINES FOR THE LEFT TURN MOVEMENT TO PASS THROUGH.
- THE PROPOSED PERMANENT MARKINGS SHALL BE LAID OUT BY THE CONTRACTOR IN ADVANCE OF THE MARKING INSTALLATION. MARKINGS SHALL NOT BE APPLIED UNTIL THE LAYOUT AND CONDITIONS OF THE SURFACE HAVE BEEN APPROVED BY THE CITY INSPECTOR.

PERMANENT MARKINGS - STANDARD MATERIALS	MARKING TYPE					PAVEMENT TYPE			
	LONGITUDINAL LINES	TRANSVERSE LINES	ON-STREET PARKING	SYMBOLS	COLORED PAVEMENT MARKING	CONCRETE	ASPHALT	MICRO-SURFACING	CHIP SEAL
METHYL METHACRYLATE (MMA)	X	X			X	X	X		
PREFORMED THERMOPLASTIC*	X	X	X	X	X	X	X	X	
PATTERNED COLD PLASTIC*	X					X	X		
CONTRAST PATTERNED COLD PLASTIC*	X					X	X		
TEMPORARY MARKINGS									
COLD PLASTIC	X	X				X	X	X	
PAINT	X	X				X	X	X	X
TEMPORARY TAPE	X	X				X	X	X	X
TEMPORARY TABS#	X					X	X	X	X

*ALLOWED WITH WRITTEN APPROVAL
#TEMPORARY TABS ALLOWED FOR LONGITUDINAL LINES, WHILE WAITING FOR PAVEMENT TO CURE

2025 EDITION SHEET ____ OF ____

DATE	BY	REVISION
04-01-25	LJM	REPLACES ALL PREVIOUS VERSIONS OF PAVEMENT MARKING DETAILS
04-01-24	LJM	REPLACES ALL PREVIOUS VERSIONS OF PAVEMENT MARKING DETAILS



STANDARD DETAILS FOR PAVEMENT MARKING GENERAL NOTES AND DETAILS

DAVID P. CRONIN CITY ENGINEER CRAIG S. OWENS CITY MANAGER

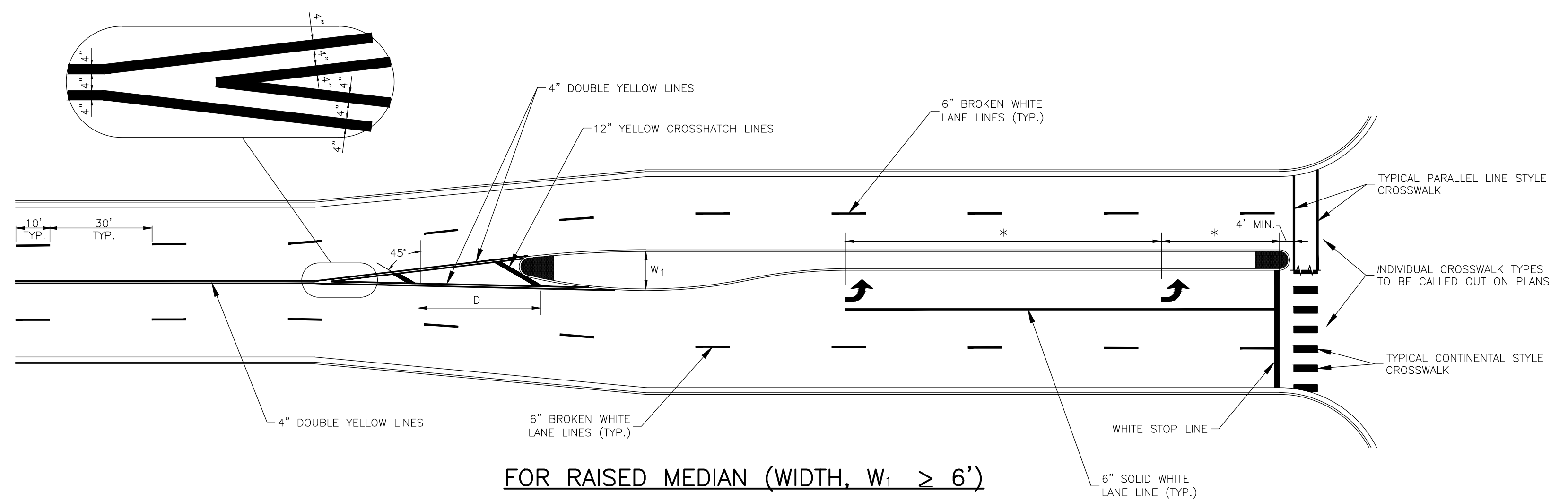

FOR RAISED MEDIAN (WIDTH, $W_1 \geq 6'$)

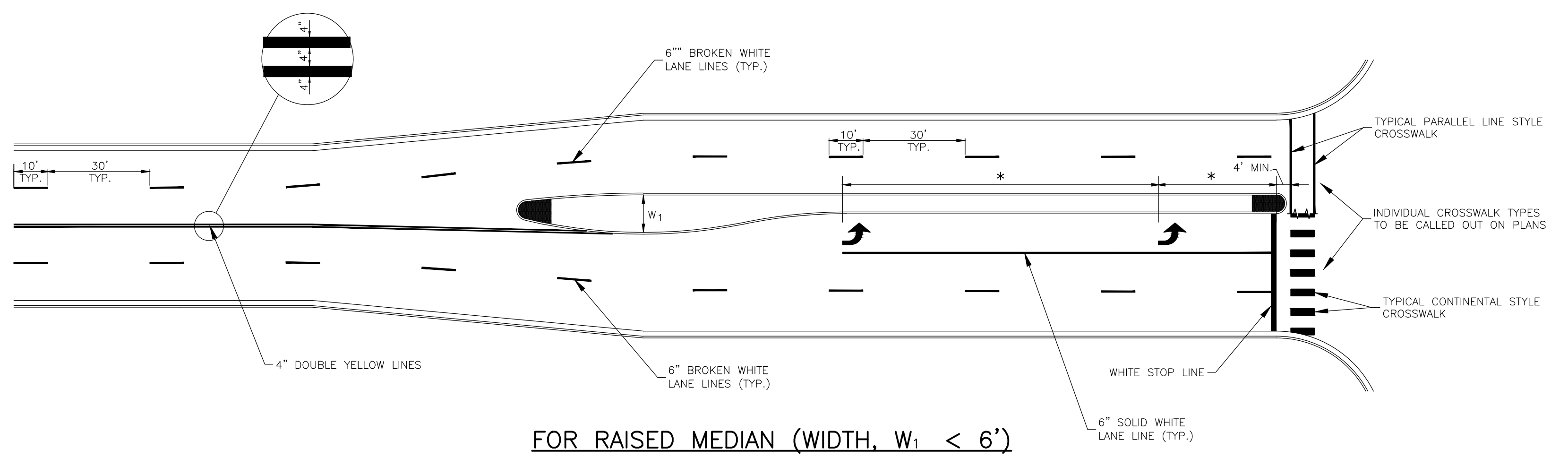

FOR RAISED MEDIAN (WIDTH, $W_1 < 6'$)

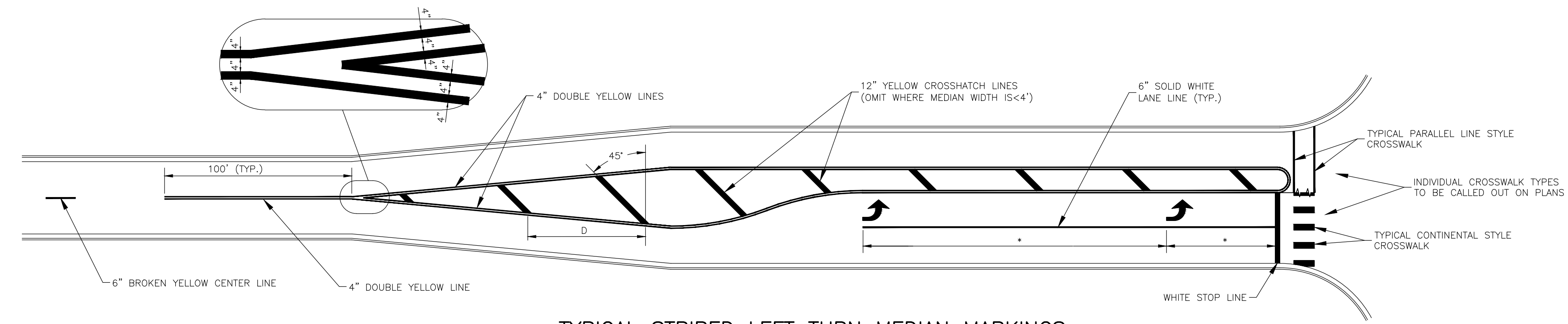

TYPICAL STRIPED LEFT TURN MEDIAN MARKINGS

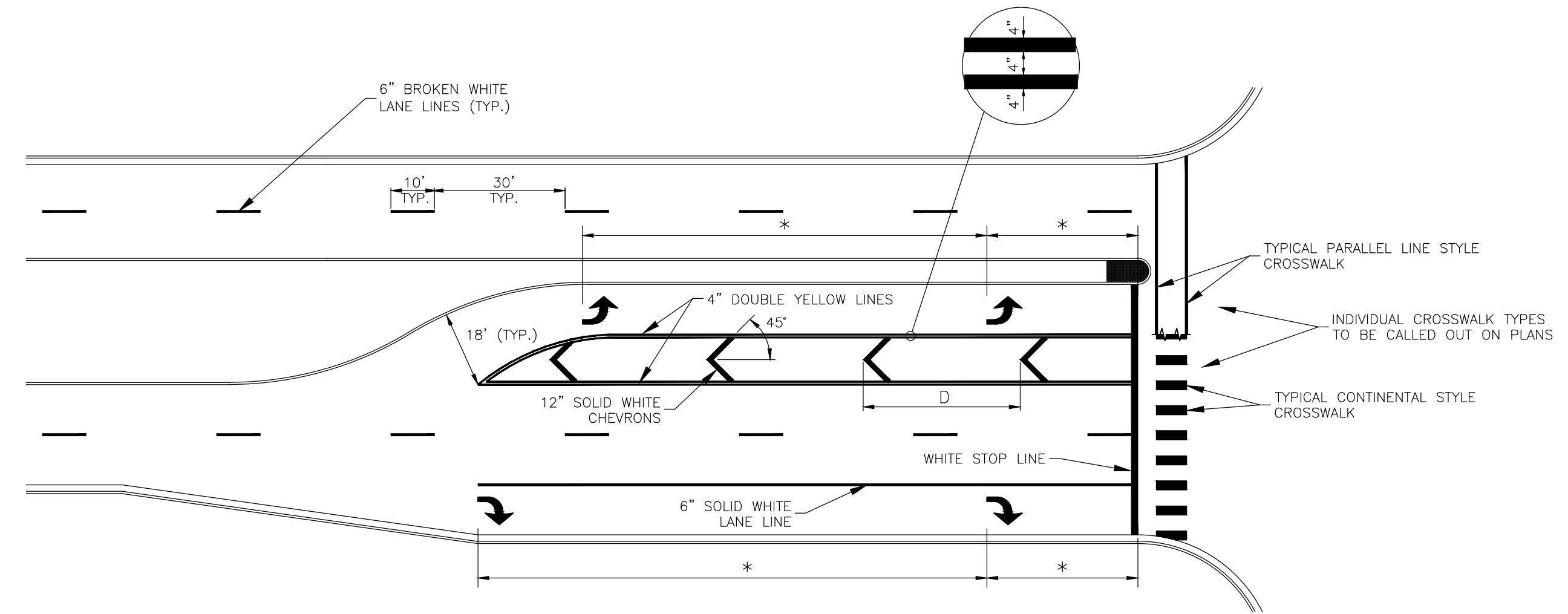

TYPICAL LEFT TURN CHANNELIZATION ISLAND LANE MARKINGS

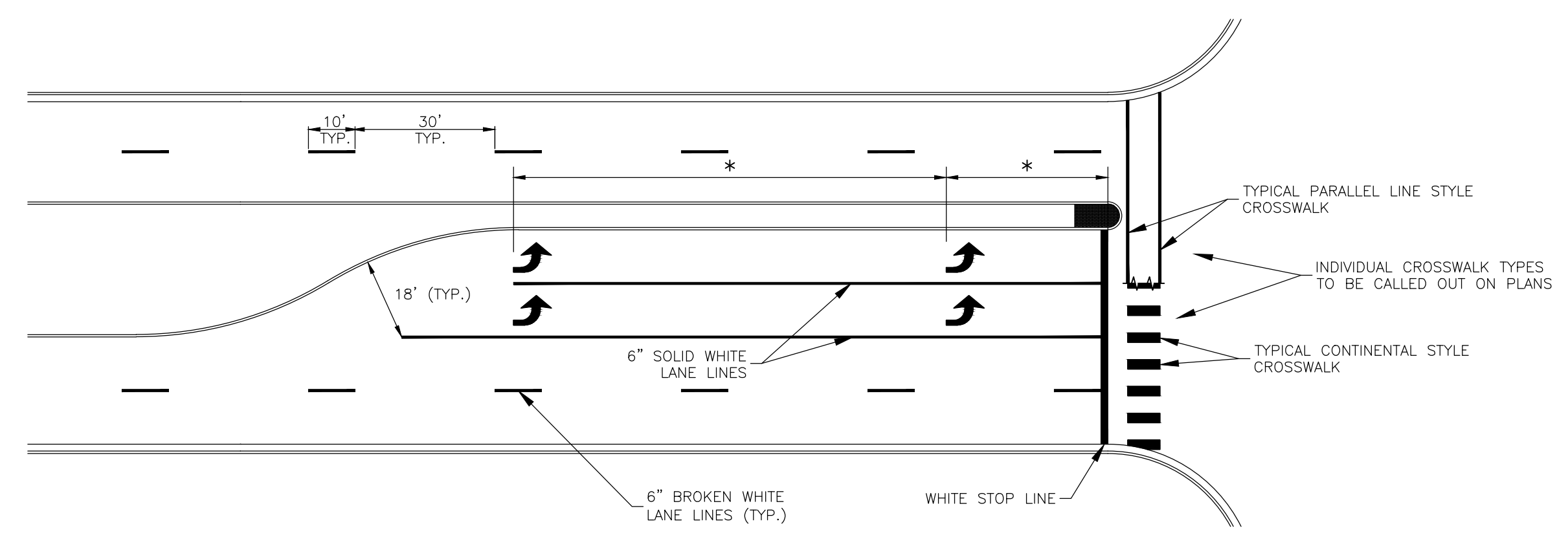

TYPICAL DUAL LEFT TURN LANE MARKINGS

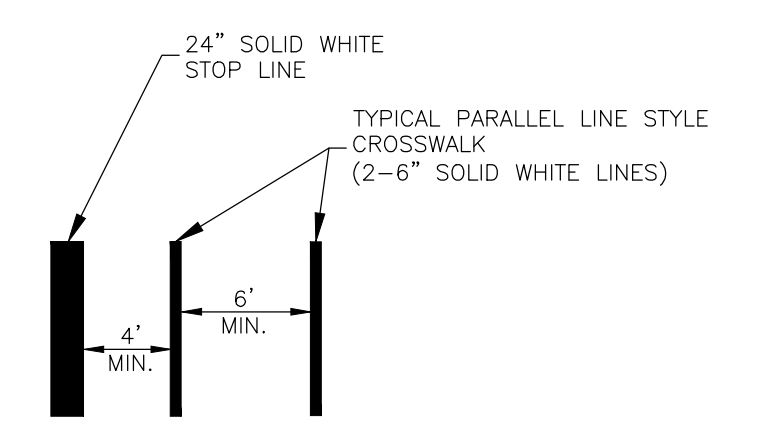

TYPICAL DETAIL OF STOP LINE AND PARALLEL LINE STYLE CROSSWALK SEPARATION

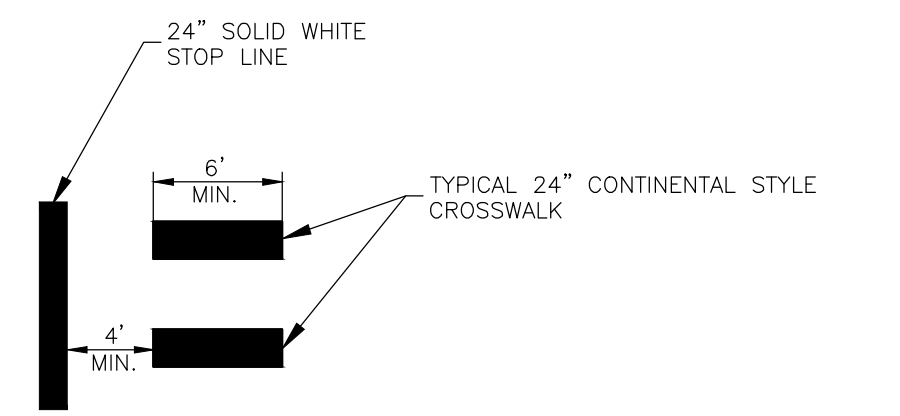

TYPICAL DETAIL OF STOP LINE AND CONTINENTAL STYLE CROSSWALK SEPARATION

NOTES:
 1) * VARIABLE, SEE SPACING SCHEDULE AND/OR PLANS FOR LOCATION.
 2) D= POSTED SPEED LIMIT IN FEET (I.E. 25 MPH = 25' SPACING) ADJUST IN THE FIELD FOR A MINIMUM OF TWO.

2025 EDITION SHEET ____ OF ____

DATE	BY	REVISION
04-01-25	LJM	REPLACES ALL PREVIOUS VERSIONS OF PAVEMENT MARKING DETAILS
04-01-24	LJM	REPLACES ALL PREVIOUS VERSIONS OF PAVEMENT MARKING DETAILS



STANDARD DETAILS FOR PAVEMENT MARKING TURNBAY PAVEMENT MARKING

DAVID P. CRONIN CITY ENGINEER CRAIG S. OWENS CITY MANAGER

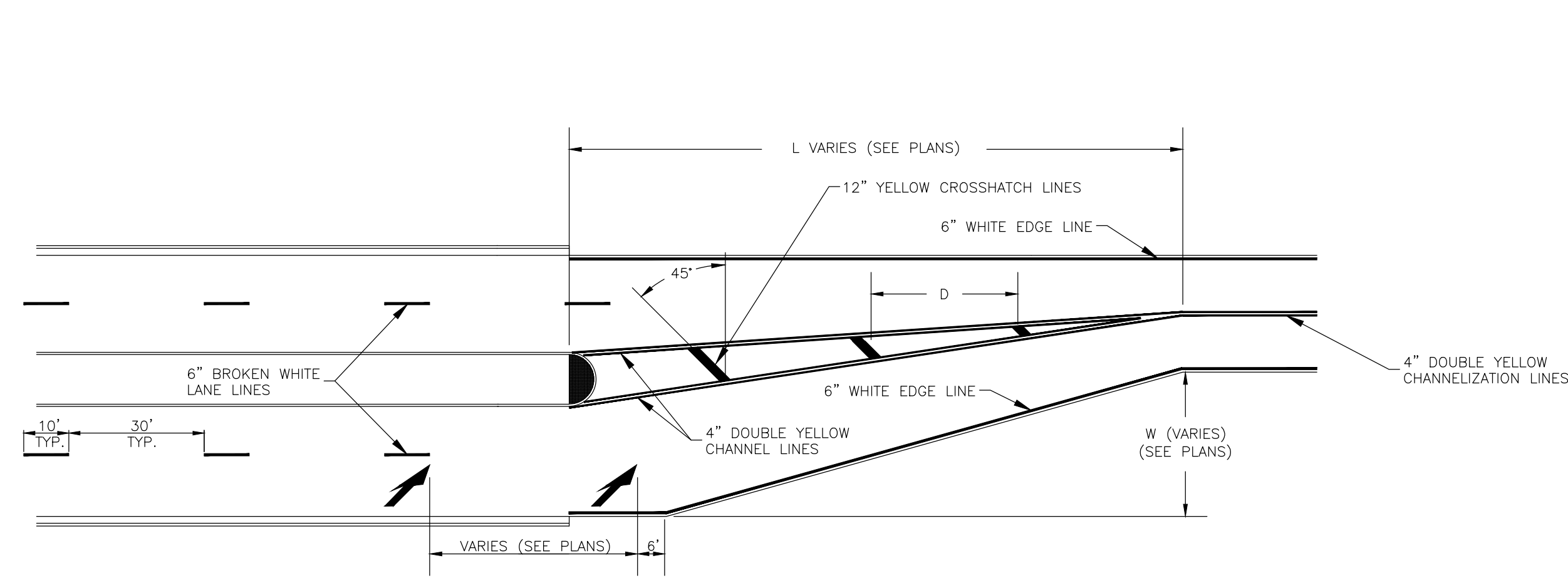

LANE REDUCTION TRANSITION MARKINGS

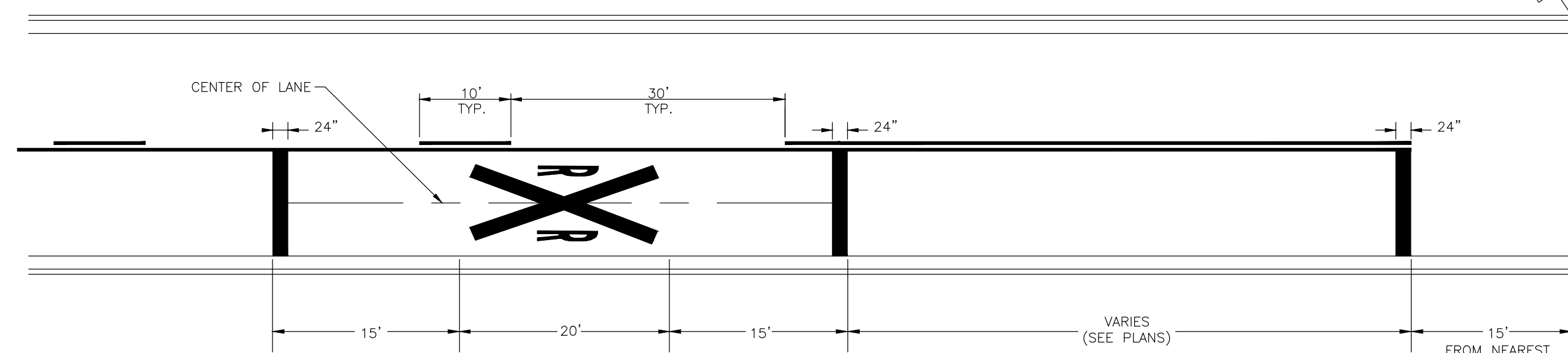

GRADE CROSSING PAVEMENT MARKINGS

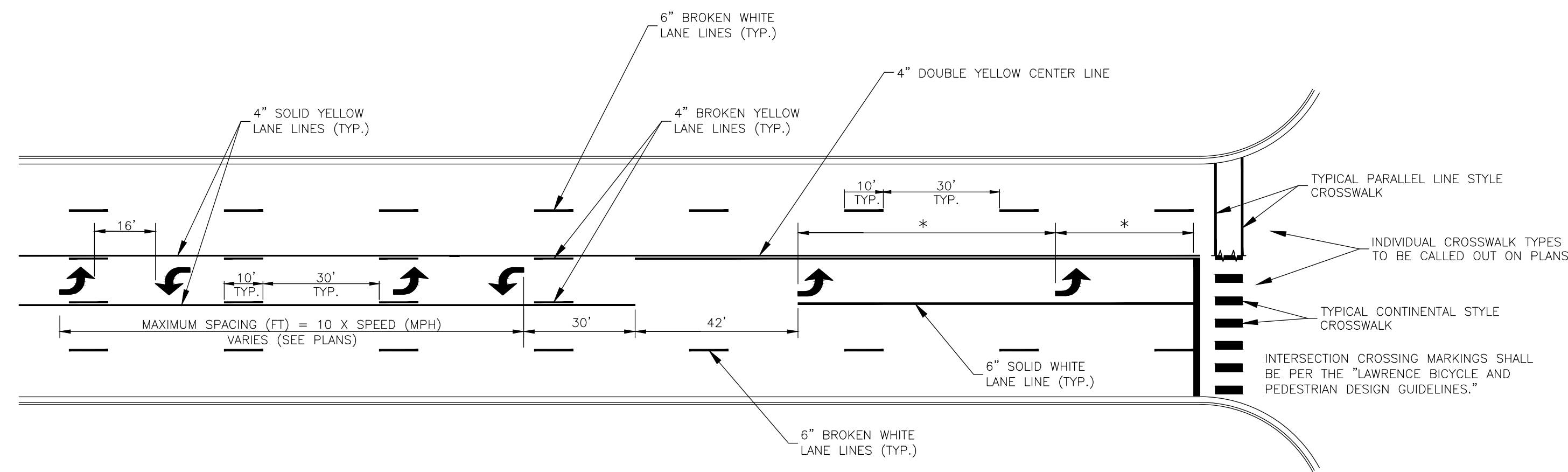

TYPICAL TWO-WAY LEFT TURN MARKINGS

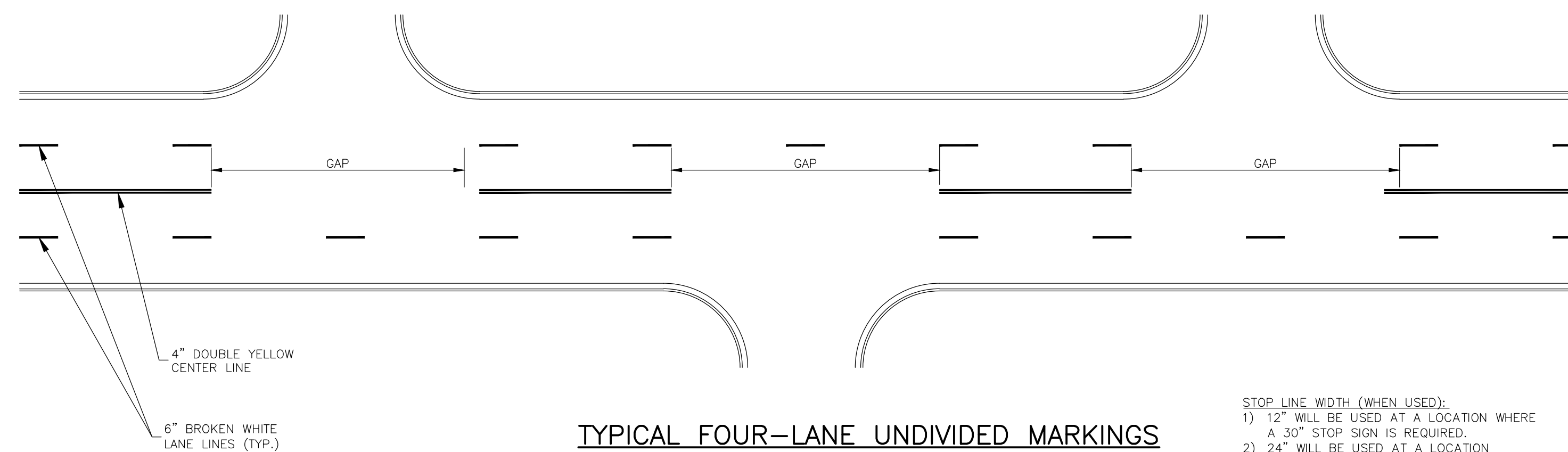

TYPICAL FOUR-LANE UNDIVIDED MARKINGS WITH SIDE STREET INTERSECTIONS

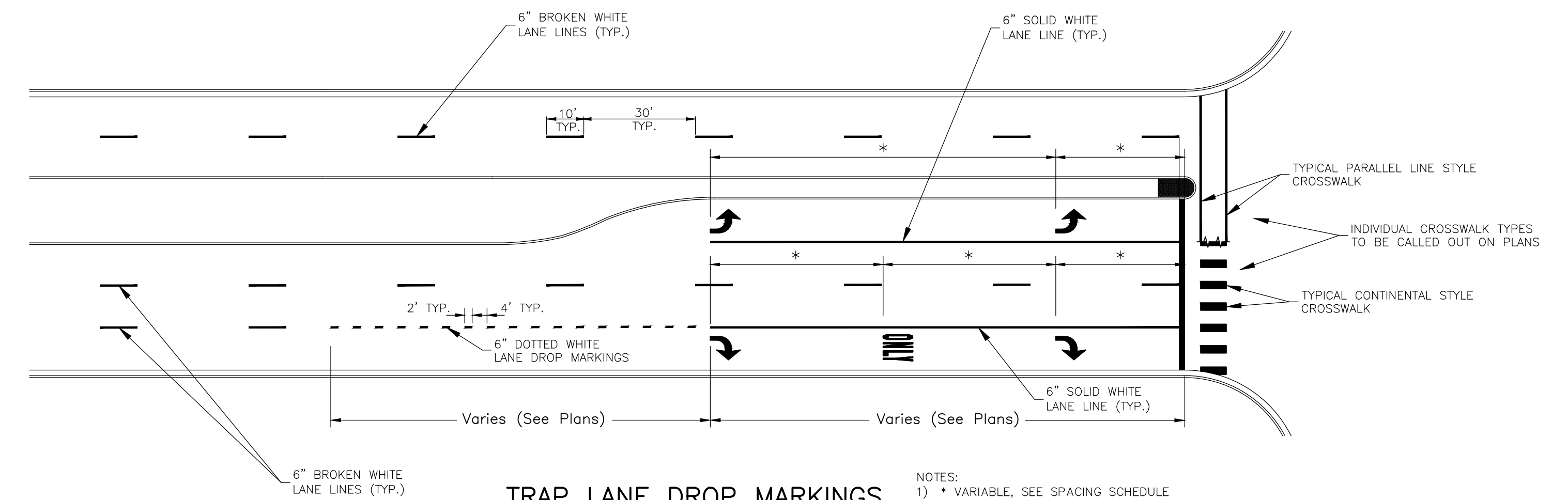

TRAP LANE DROP MARKINGS

NOTES:
 1) * VARIABLE, SEE SPACING SCHEDULE AND/OR PLANS FOR LOCATIONS.
 2) D= POSTED SPEED LIMIT IN FEET (I.E. 25MPH = 25' SPACING) ADJUST IN THE FIELD FOR A MINIMUM OF TWO.

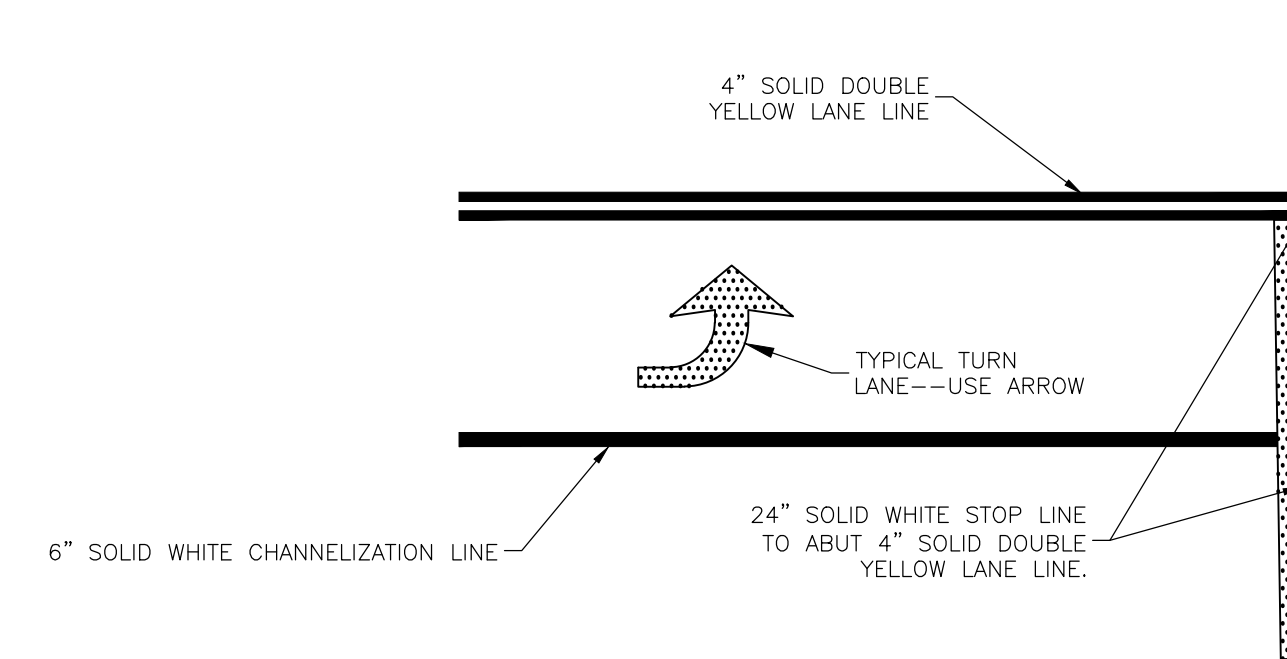

TYPICAL DETAIL FOR LAYOUT OF 24" SOLID WHITE STOP LINE AND 4" SOLID DOUBLE YELLOW LANE LINE

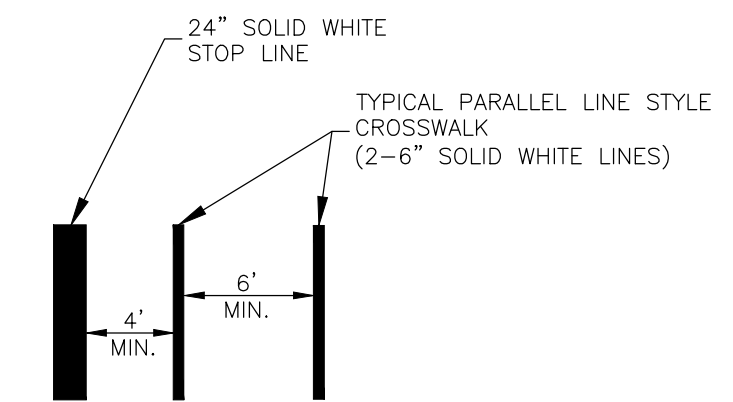

TYPICAL DETAIL OF STOP LINE AND PARALLEL LINE STYLE CROSSWALK SEPARATION

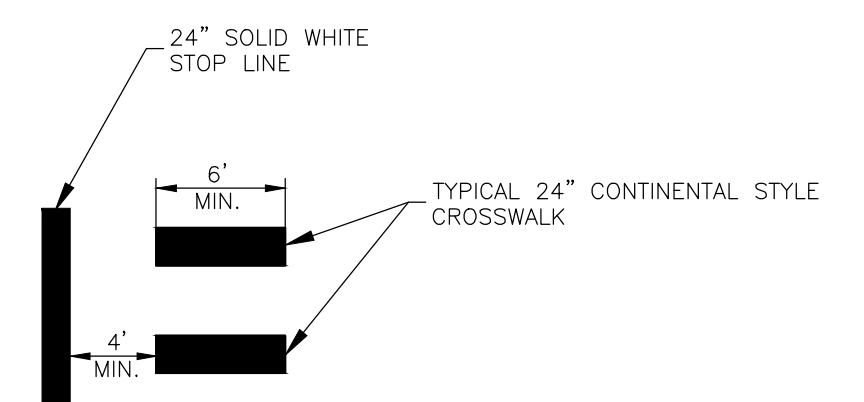

TYPICAL DETAIL OF STOP LINE AND CONTINENTAL STYLE CROSSWALK SEPARATION

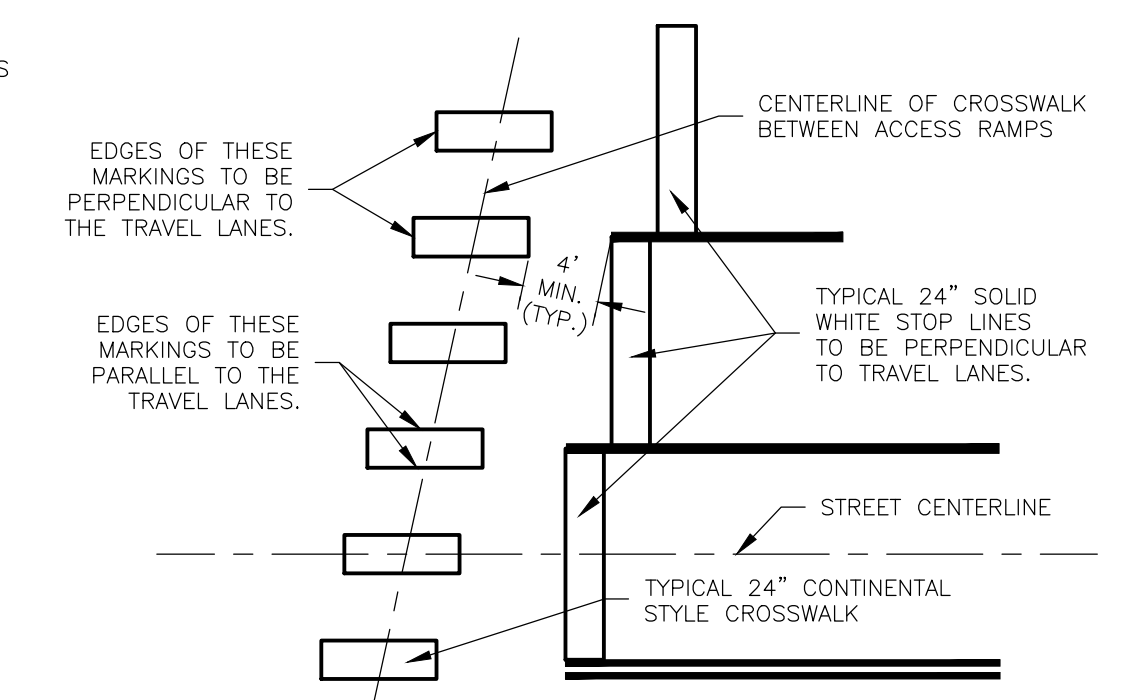

TYPICAL LAYOUT DETAIL FOR SKEWED CONTINENTAL STYLE CROSSWALK MARKINGS

STOP LINE WIDTH (WHEN USED):
 1) 12" WILL BE USED AT A LOCATION WHERE A 30" STOP SIGN IS REQUIRED.
 2) 24" WILL BE USED AT A LOCATION WHERE A 36" STOP SIGN IS REQUIRED.
 3) 24" WILL BE USED AT ALL CONTROLLED APPROACHES TO A TRAFFIC SIGNAL.

2025 EDITION SHEET ____ OF ____

DATE	BY	REVISION
04-01-25	LJM	REPLACES ALL PREVIOUS VERSIONS OF PAVEMENT MARKING DETAILS
04-01-24	LJM	REPLACES ALL PREVIOUS VERSIONS OF PAVEMENT MARKING DETAILS



STANDARD DETAILS FOR PAVEMENT MARKING MISCELLANEOUS PAVEMENT MARKING 3 OF 6

DAVID P. CRONIN CITY ENGINEER CRAIG S. OWENS CITY MANAGER

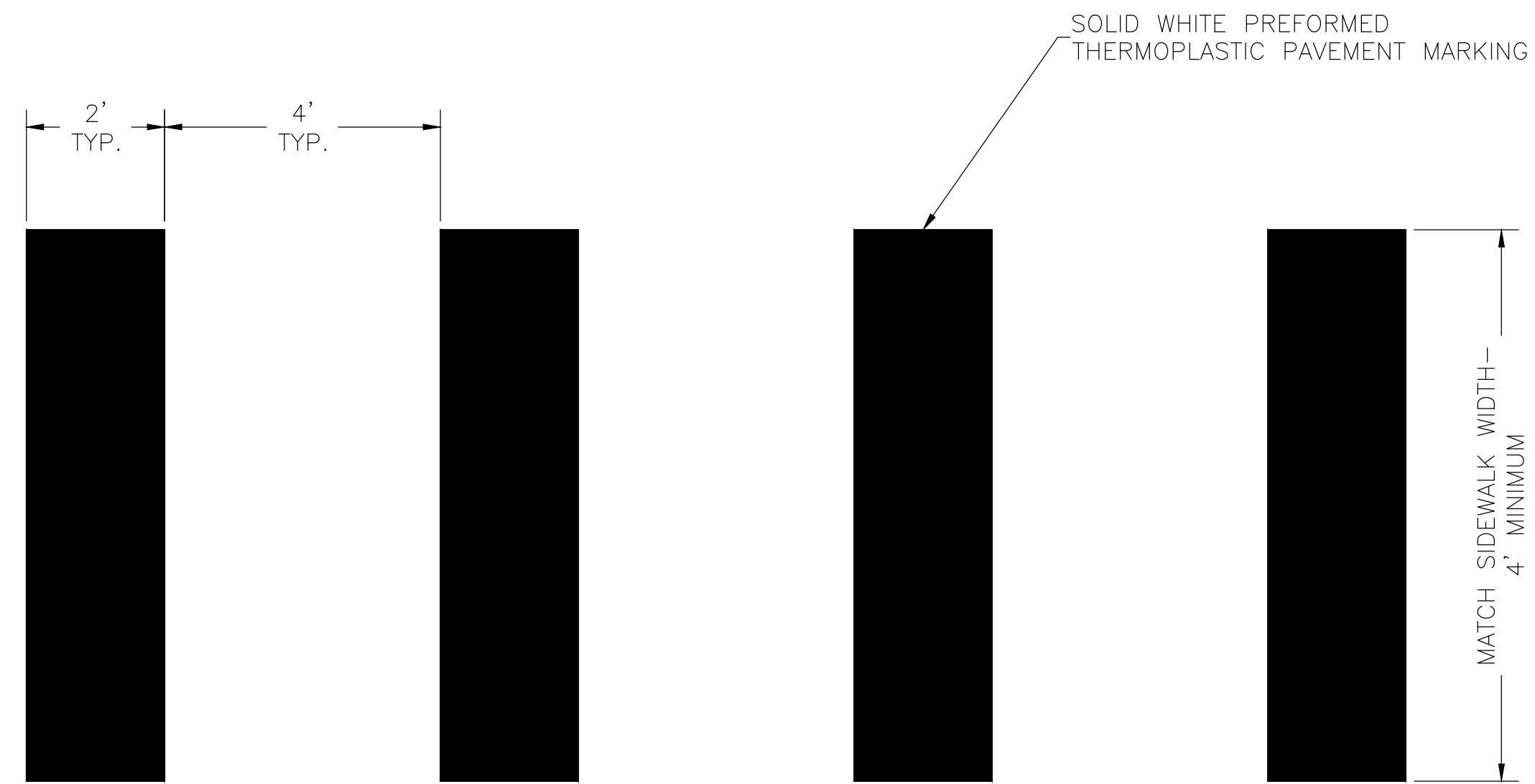

CONTINENTAL CROSSWALK MARKING DETAIL

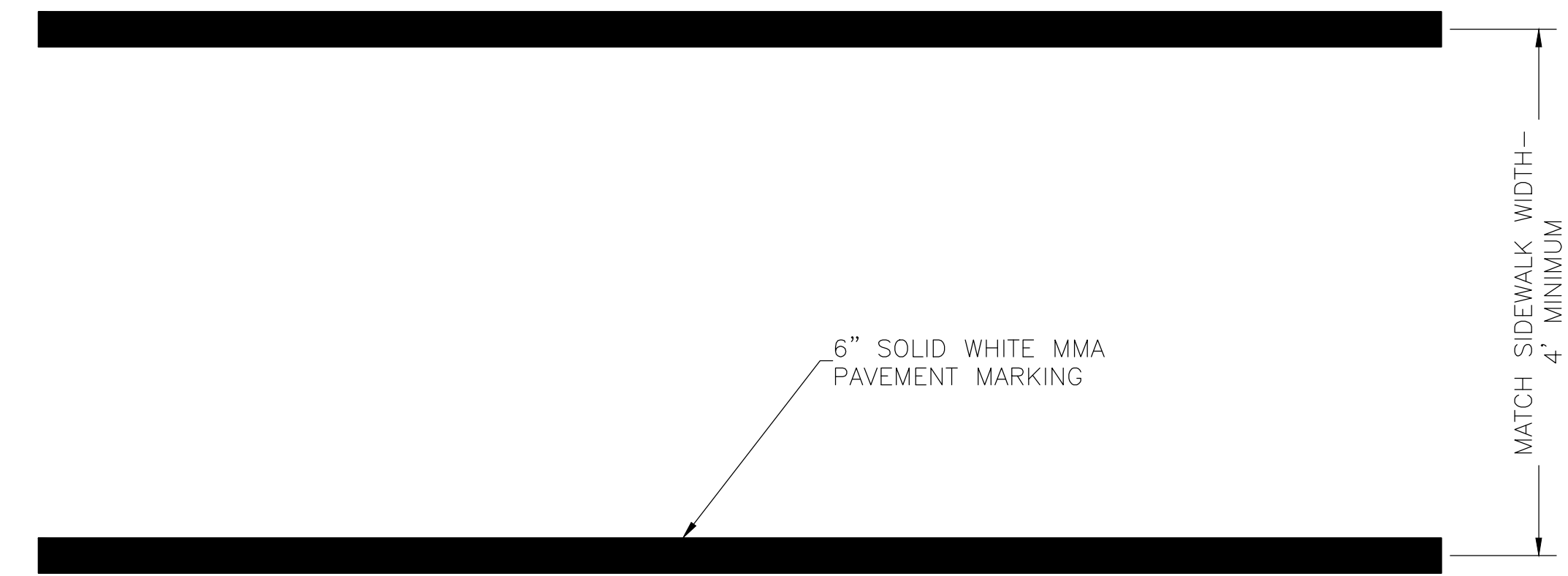

STANDARD CROSSWALK MARKING DETAIL

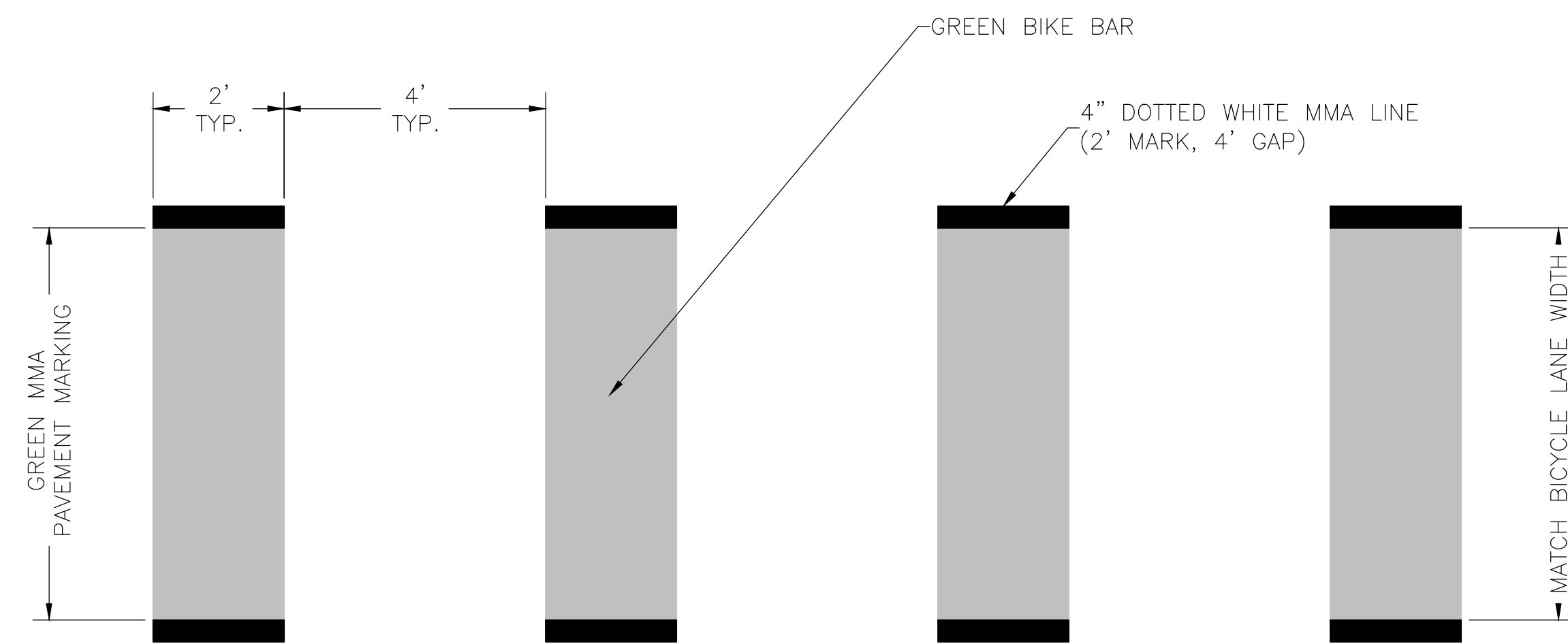

BICYCLE CONFLICT CROSSING MARKING DETAIL

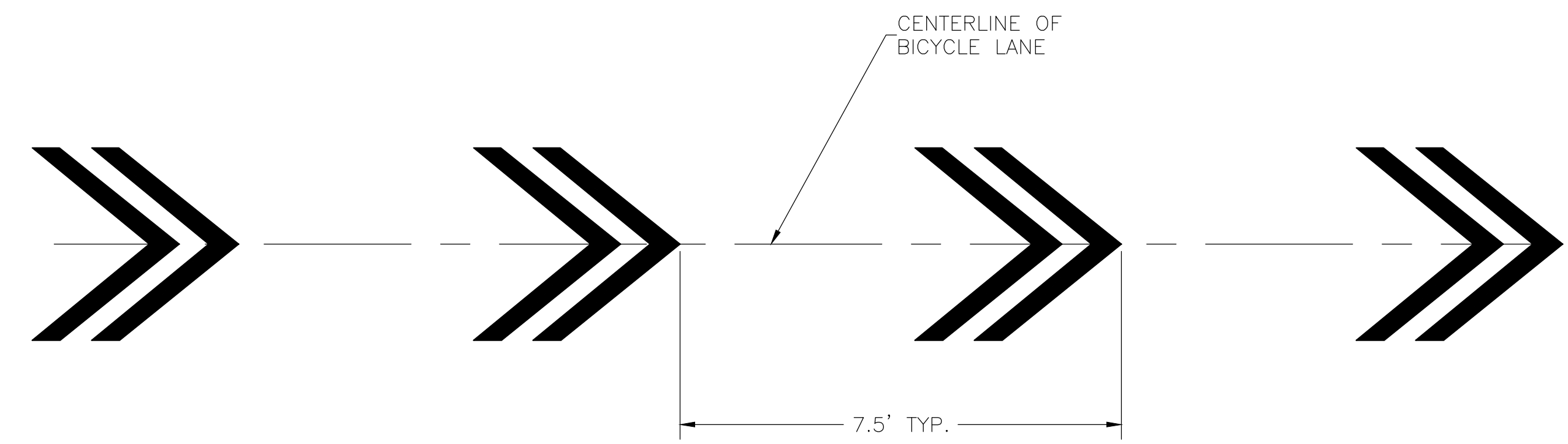

CHEVRON LAYOUT DETAIL

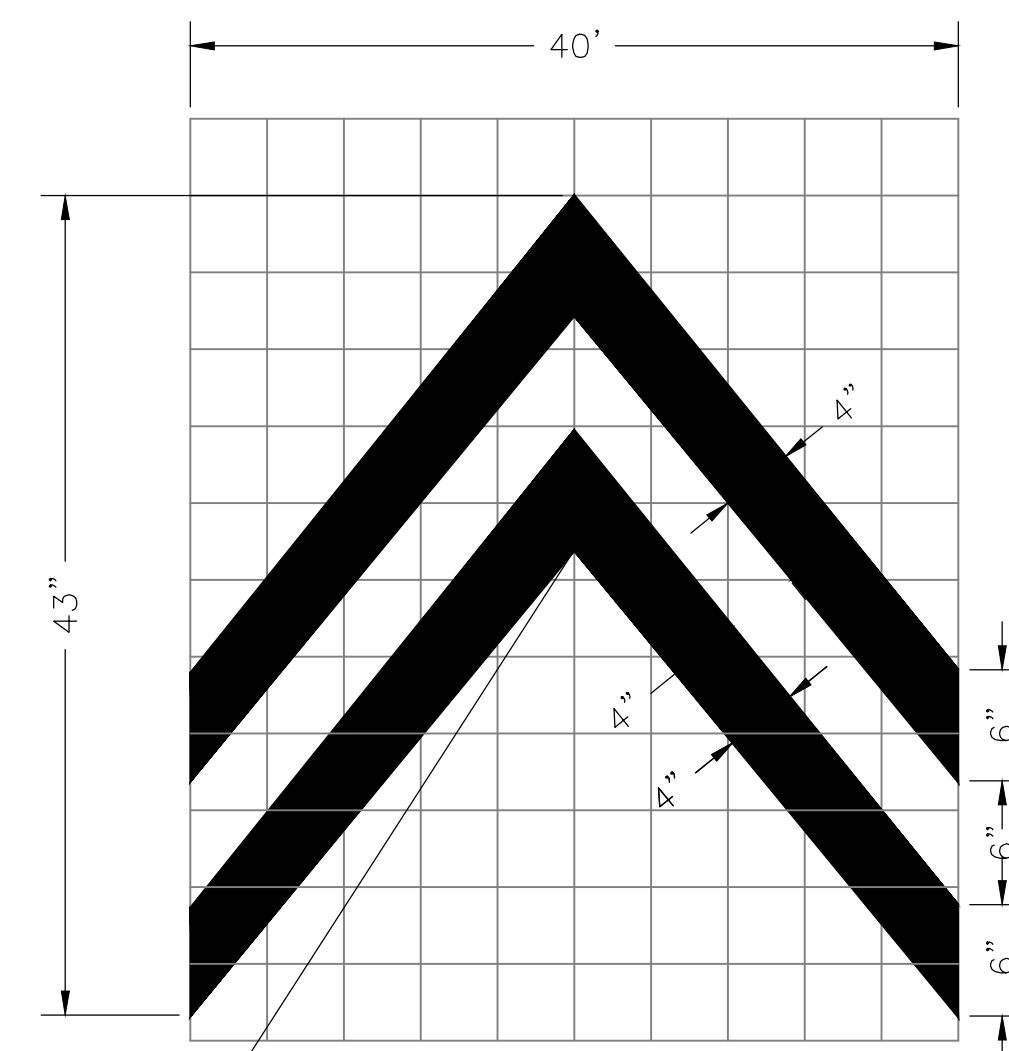

BICYCLE CHEVRON DETAIL

2025 EDITION SHEET ____ OF ____

DATE	BY	REVISION
04-01-25	LJM	REPLACES ALL PREVIOUS VERSIONS OF PAVEMENT MARKING DETAILS
04-01-24	LJM	REPLACES ALL PREVIOUS VERSIONS OF PAVEMENT MARKING DETAILS



STANDARD DETAILS FOR PAVEMENT MARKING BICYCLE MARKINGS

5 OF 6

DAVID P. CRONIN CITY ENGINEER CRAIG S. OWENS CITY MANAGER

